



Connect Palette 3 to Internet and Canvas

This article will demonstrate how to connect Palette to the Internet as well as your Canvas account!!

Written By: Mosaic Support



Canvas

INTRODUCTION

In this guide you will learn how to:

- Connect Palette to the Internet using Wi-Fi on Palette 3, WiFi and ethernet on Palette 3 Pro.
- Toggle Wi-Fi on/off, disconnect and forget Wi-Fi networks.
- Connect Palette to your Canvas account.

Step 1 — Connect to Internet

Connect to Internet

With network connection, Palette can download updates directly, find the best calibration preset for your printer, and link to Canvas.

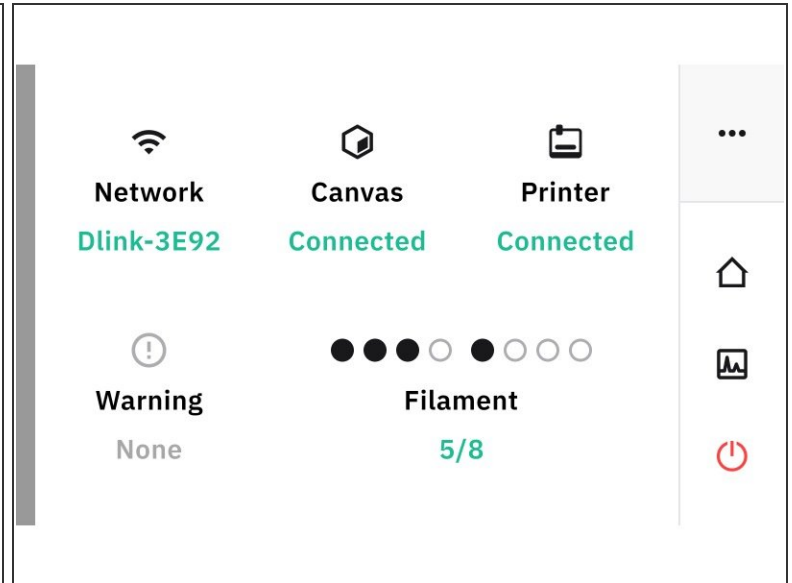
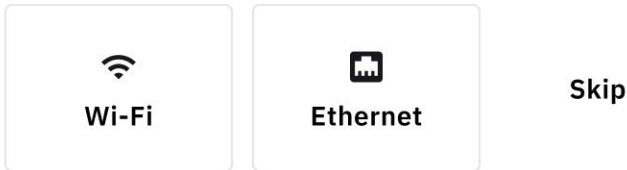

- During the initial setup, after accepting the Terms of Service you can connect to the internet.
 - ❗ Connecting Palette 3 to the Internet will allow for firmware updates to be completed wirelessly, and will make printer profile presets available. Additionally, it will allow you to connect Palette to your Canvas account.
- There are two options for connecting to the internet: Wi-Fi (Palette 3, Palette 3 Pro) or Ethernet (Palette 3 Pro only).
 - ★ If you skip connecting to the Internet during the initial setup, you can always connect from the side menu later.

Step 2 — Connect Using WiFi

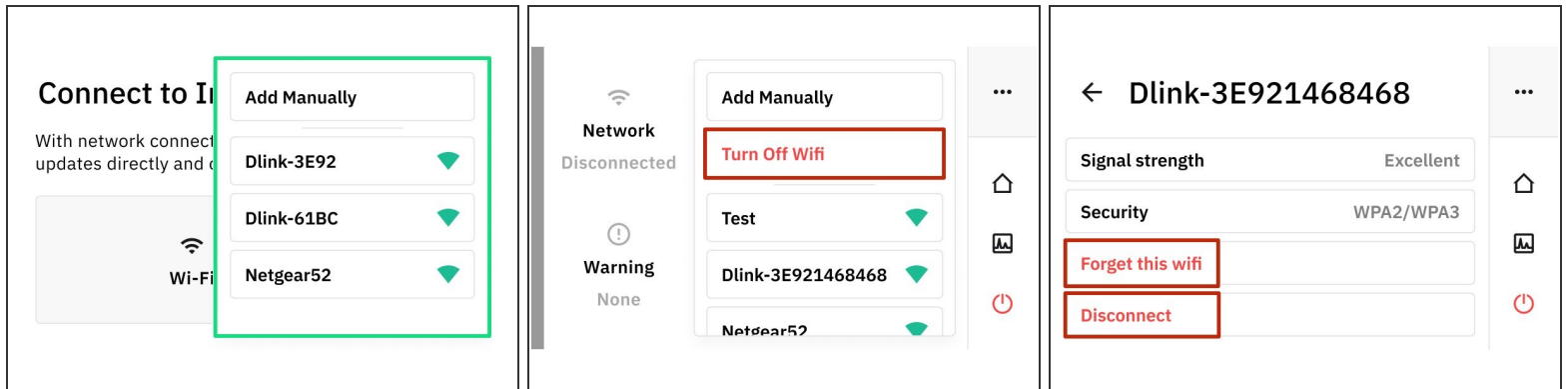

- To connect to Wi-Fi: Tap *Wi-Fi* and choose an existing network from the list, or manually add a network using an SSID and a password.
- ❗ In case there are issues connecting to Wi-Fi during this initial setup, this can be skipped and entered again from the side menu.
- Wi-Fi options from the side menu include toggling the Wi-Fi on/off, disconnecting and forgetting networks if needed.

Step 3 — Connect Using Ethernet

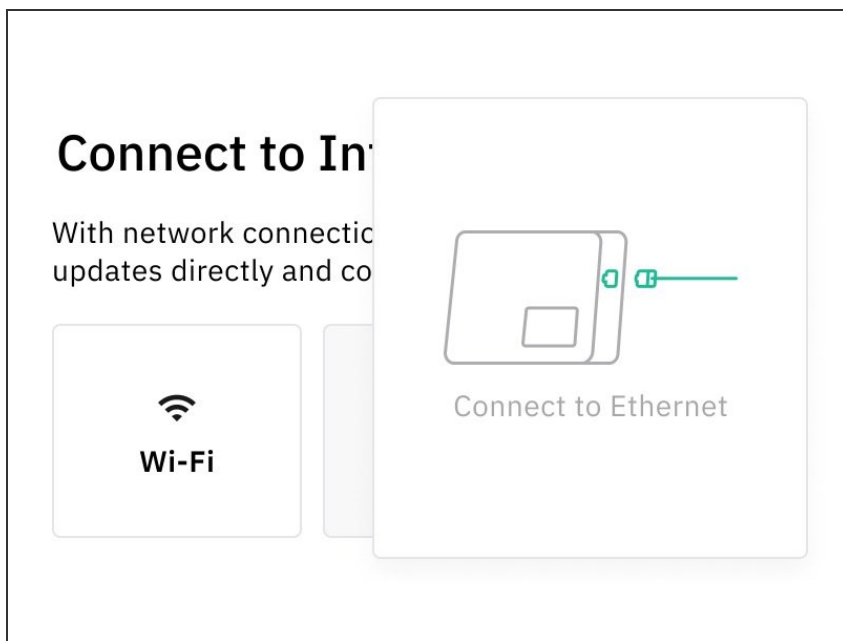

- Ethernet connection is available on Palette 3 Pro.
- To Connect to Ethernet: Click *Ethernet* to connect using an ethernet cable, and insert the cable into the port.
- ❗ Once an ethernet cable is plugged in, Palette 3 will automatically proceed with the Ethernet connection over Wi-Fi.
- ★ If you skip this step during the initial setup, an Ethernet connection can be established at anytime by plugging in the cable.

Step 4 — Login and Link to Canvas

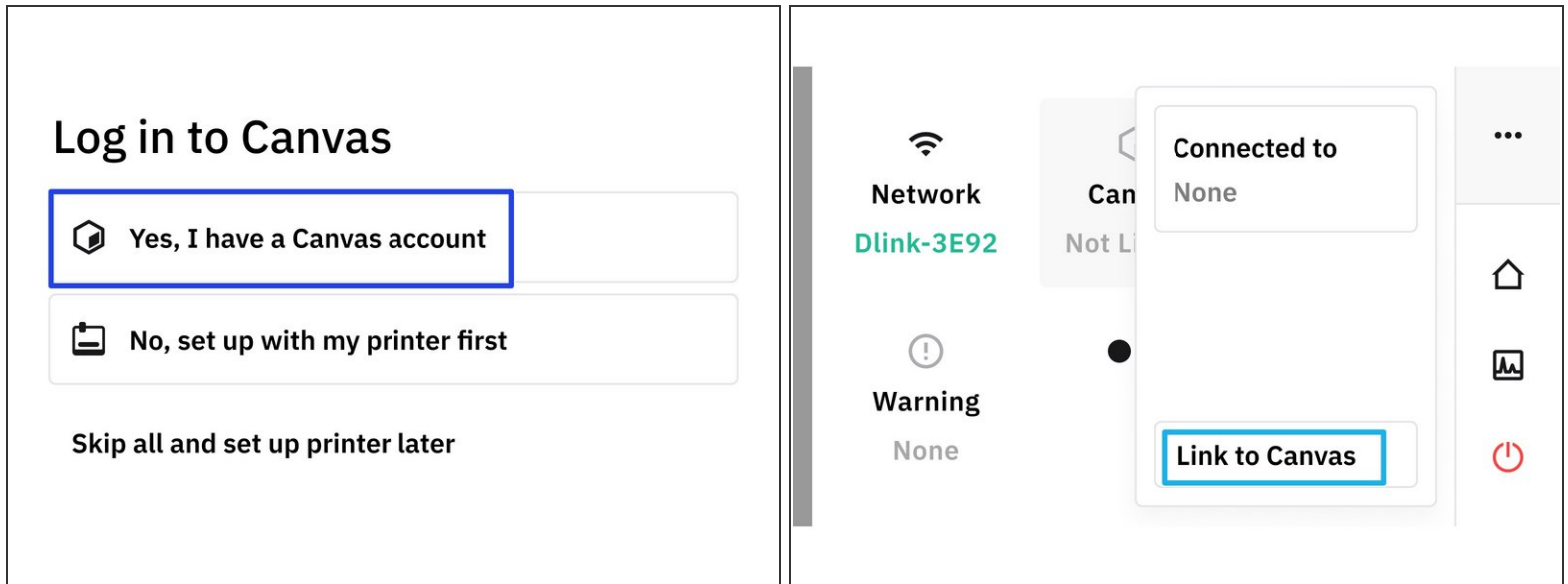

-  Once your Palette is connected to the Internet, you will be able to login to your Canvas account.
- A Canvas account can be created [here](#). Connecting Palette to your Canvas account (with Internet) will allow for prints to be sent and monitored from Canvas.
 - ☒ If you skip connecting to Canvas during the initial setup, you can always connect your Canvas account from the side menu later.
 - Click Link to Canvas. This will provide you with an activation code to connect Palette to Canvas

Step 5 — Enter Activation Code and Connect to Canvas

Continue on Canvas

Please visit canvas3d.io/connect and use the code below.

5 6 2 5

Refreshing in 01:59

Back

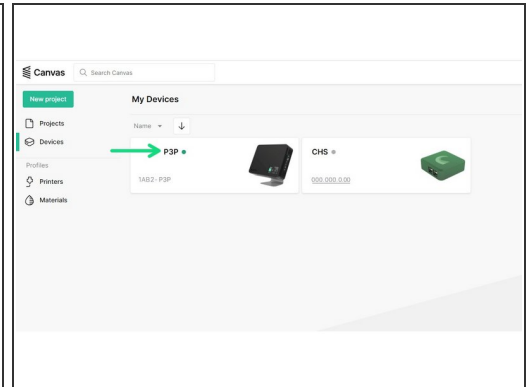
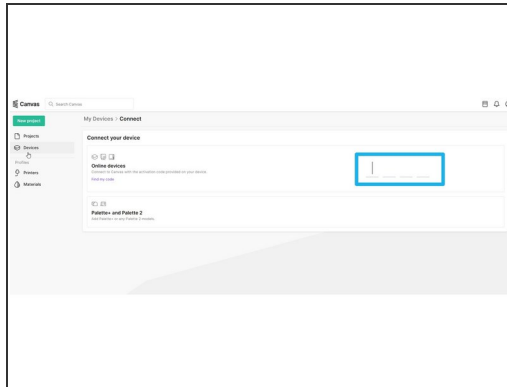

- An activation code is generated on Palette.
- Enter the activation code beside *Online devices*. Login to Canvas on another computer and visit: canvas3d.io/connect. This is also available from the *Main menu > Devices > Connect device*.
- Palette should now be connected to your Canvas account!

If you have any additional questions, please send us a message at support@mosaicmfg.com.