

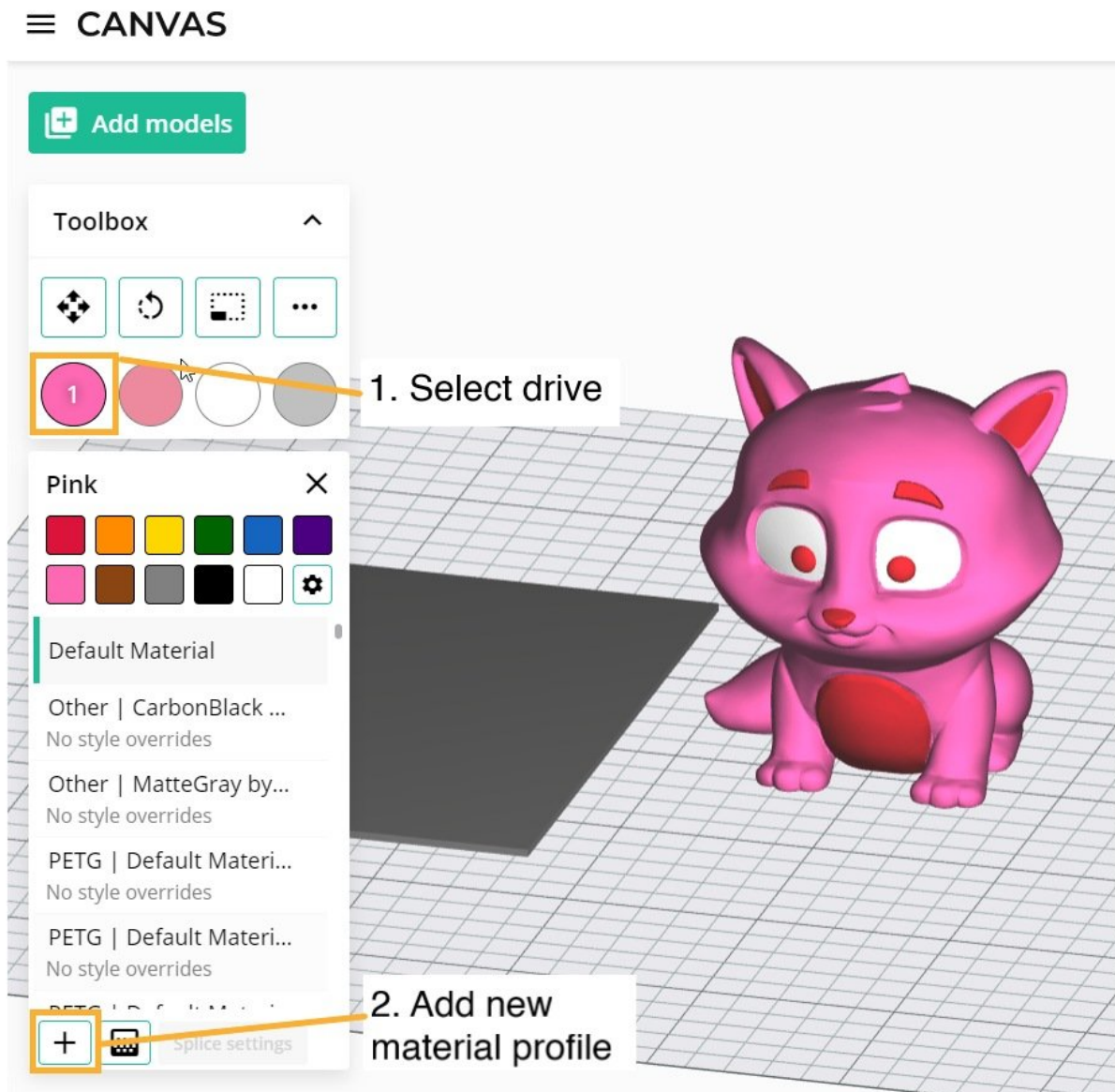

How to Add Style Overrides to Material Profiles

How to create custom material profiles with specific settings for when the material is printed.

Written By: Mosaic Support



INTRODUCTION

You will learn how material profiles can be used with custom print settings in Canvas. Style overrides allows a specified print setting to be used when a material is selected.

Step 1 — Create a New Material Profile

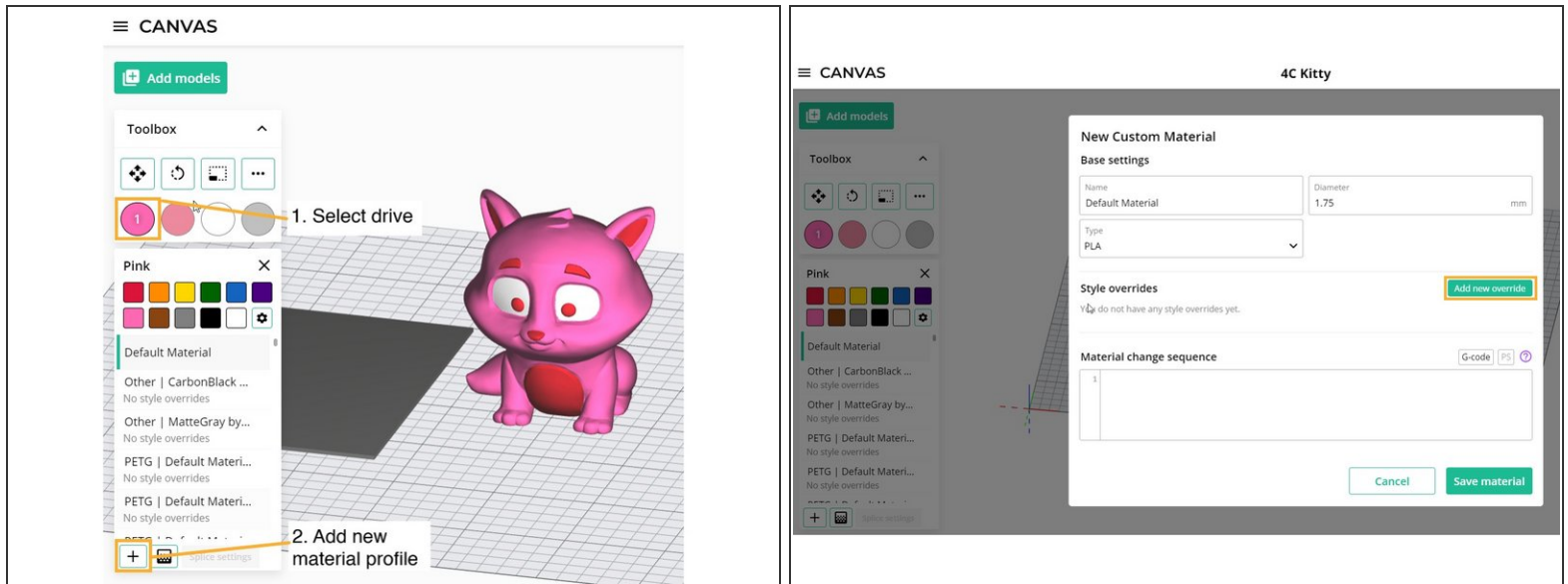

- You can create a new material profile if you have a project open, or directly from the Material Profiles menu.
- A custom material profile can have different style or slicer settings saved to it.

Step 2 — Add a Style Override to the Material Profile

The image shows two screenshots of the 'New Custom Material' interface. The left screenshot shows the 'Style overrides' section with a list of settings and an 'Add new override' button. The right screenshot shows the 'Style overrides' section with a 'Maximum print speed' override added and a 'Save material' button highlighted.

New Custom Material

Base settings

Name: Silk PLA Diameter: 1.75 mm

Type: PLA

Style overrides

You do not have any style overrides yet.

Material change sequence

1

Style overrides

Maximum print speed: 30 mm/s

Material change sequence

1

Buttons: Add new override, Cancel, Save material

- Style overrides are slicer settings that are applied only when that material profile is selected for an input drive or color input.
- You can add multiple style overrides to a material profile.
- Style overrides include: extrusion multiplier, retraction distance, retraction speed, wipe distance, maximum print speed, print temperature, first layer temperature, use cooling fan, start fan at layer, general fan speed, perimeter fan speed, tower print speed, maximum bridging speed.
- Save the material after adding the desired style overrides.

Step 3 — Select the Material Profile for Palette's Inputs

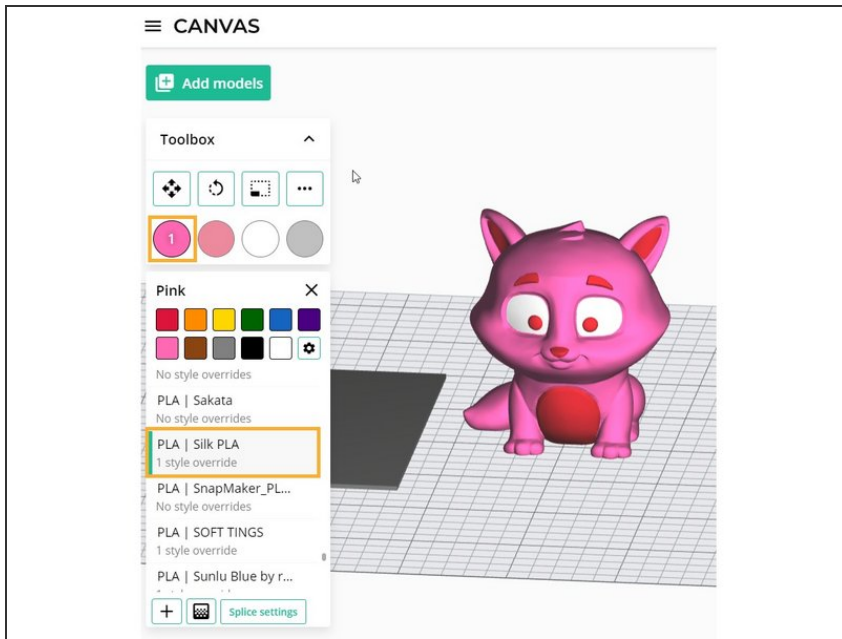

- After saving and returning to the project view, click on an input drive color in the toolbox, in order to select the material to be used for drive.
- Any models that are colored or painted with this input drive color, should now also use the custom material profile selected when going to print.